

Pneumatic pump mounted on drum BN45

Applications

These pumps are designed to work with grease and oil, whatever environment, as long as there is compressed air, these pumps are used in installations with any type of flow.

Features

- ▶ Compact
- ▶ Low air consumption
- ▶ For grease and oil
- ▶ Built-on safety valve
- ▶ Control speed by means of PLC
- ▶ Available with standard drum rods 60 Kg and 200 Kg

Description

High pressure pneumatic pump with pneumatic actuation by means of a 4-way solenoid valve, 2 positions.

Adjustable capacity according to the lubrication points.

It is complemented with Nortek tanks of 5, 10 kg (3 and 20 kg on request) to be chosen by the client according to their needs.

Design and operating principle

Operation is similar to most of the double action piston pumps. The pump is pneumatically operated by the solenoid valve and stops completely only in the upward stroke, performs the down stroke due to the change of the solenoid valve.

The air pressure is exerted simultaneously by the solenoid valve through the inlet and relief holes A and B, this causes the movement of the piston as shown in "Figure 1" and effects the greasing by the outlet C.

Installation

It is installed on any standardized grease or oil drum, attached to the Nortek cap ref. 4404103.000

The installation is carried out with an electrical panel designed by Nortek type 2058914N-S_AL, from here the basic functions are regulated such as machine downtime or lubrication time, besides having the possibility of regulating the speed, its cycle regulation by Standard stroke is 1 s (1 s Greasing / 1 s Stop).

In double lines is necessary to install a return rod in order to facilitate the return to the drum. Normally the lubrication in this kind of installations is made with grease.

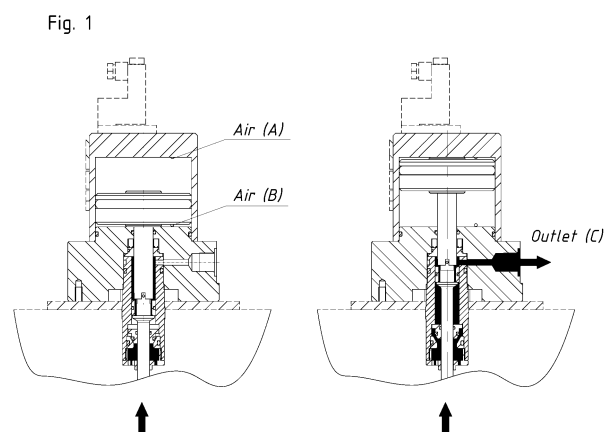

Illustration of operating principle

Specifications

Ratio	45 : 1
Maximum working pressure	300 bar
Recommended air pressure	< 9 bar
Recommended maximum speed	1 cycle/second
Air inlet	G 1/8
Grease outlet	G 3/8
Flow	4 cm ³
Approximate weight	4,5 kg

Plan dimensionnel

Dimensions en mm

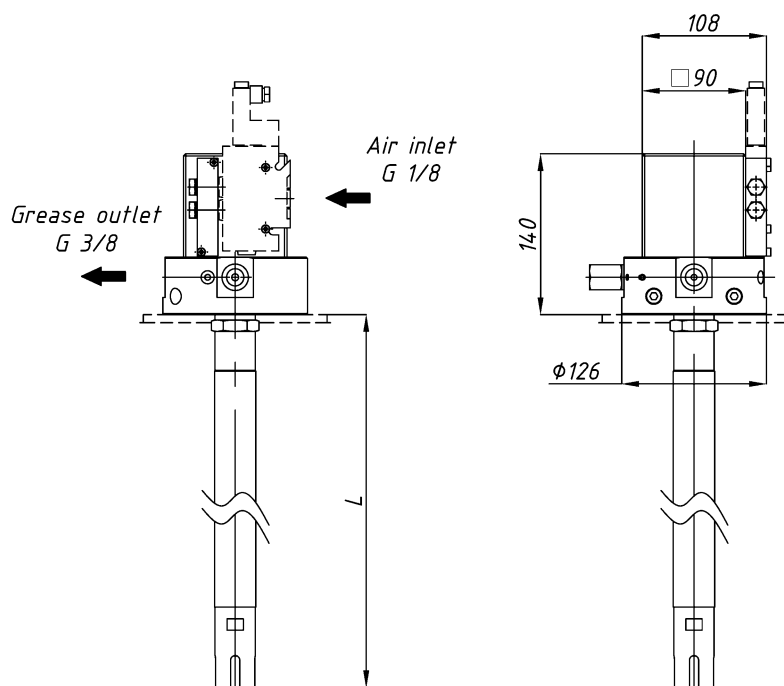

Specifications	L (mm)
200 liters drum	894
60 liters drum	644

Ordering information

ADD CODE DEPENDING ON ASSEMBLY

	BN45-	XXX	X	X	(-XX)
Specifications					
Ratio pump 50:1 without rod		000	N		
Ratio pump 50:1 for 60 litres drum		060			
Ratio pump 50:1 for 200 litres drum		200			
Return rod					
Without return rod			N		
With return rod			C		
Drum cover					
Without drum cover				N	
With drum cover				T	
Special code					
For non-standard elements					(-XX)